

*Any Way You Want
to Slice It, a* **RYAN** *is Always Best*
Technology, Inc.

Product Specification Sheet

Ryan Model 894 In-Line Side-Hinge Slicer

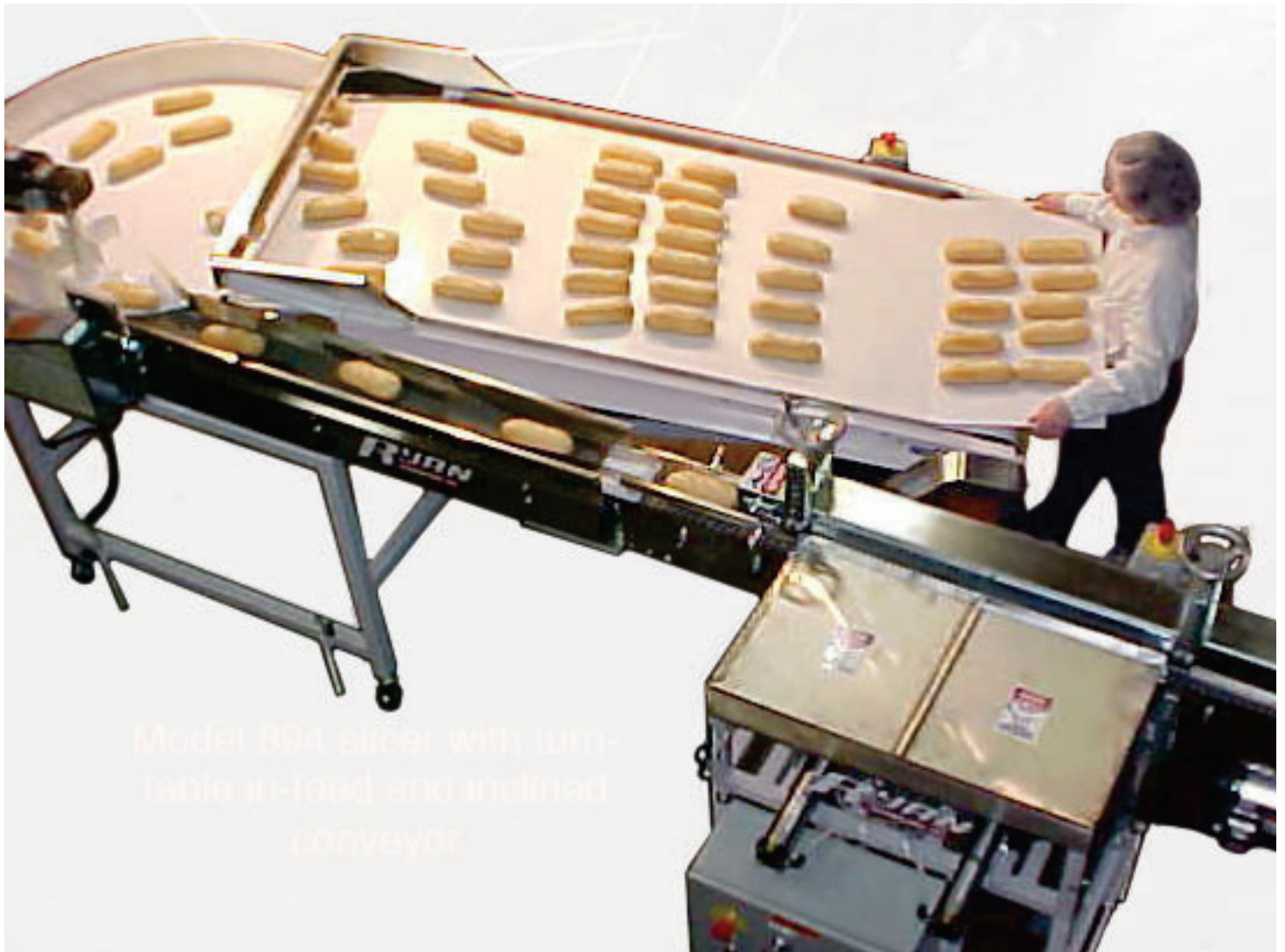

Model 894 slicer with turn-
table in-feed and inclined
conveyor

*Model 894 Slicer shown with Model 797 In-feed unit

Ryan Model 894 In-Line Side-Hinge Slicer

High-speed single-line horizontal slicer for sub-rolls, bagels, English muffins, buns, ciabatta, etc.

Capacity: Up to 400 units per minute.

Will handle product up to 6" in width and 3" tall.

Standard Features:

6" wide conveyor with Intralox friction top chain

Can flow product through without cutting in Neutral mode

Adjustable upper conveyor to slow product after blades

Stainless steel frame

1 HP motors on blades with brakes to stop blades within one revolution upon shut-down

Coded magnetic safety switches on blade access doors that allow operation only when door is closed

Two 14" circular saw blades

Air-operated blade change system (60 lb.+ air supply needed)

Air pressure regulator and oiler on board

Adjustable for cut height, depth, and product width

Factory adjustable conveyor speed

3-Phase power (208, 240, 480 volt) 20 amp

Adjustable conveyor bed height via screw-in-type feet

Options:

Ryton coating on blades

Conveyor bed adjustable height for blade cut, adds 6" to conveyor length (independent of feet)

PLC or VFD conveyor variable speed drive

Crate Size: 84" x 61" x 64" H

©2/2019

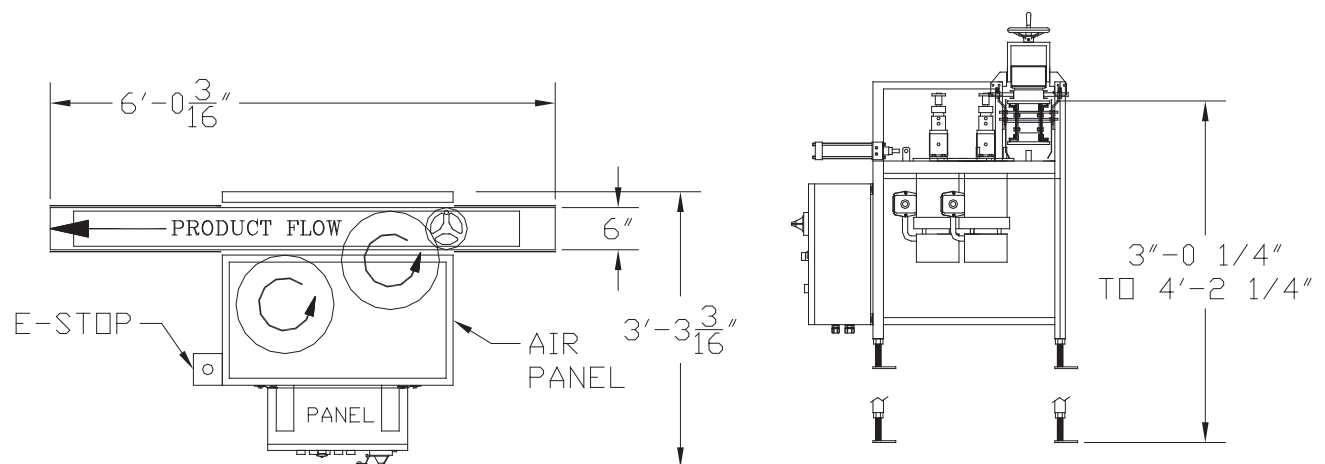

RYAN
TECHNOLOGY, INC.

1-800-277-2290 • 503-648-9967 • 503-640-3846 (Fax) • www.RyanSlicer.com

P.O. Box 1960 Hillsboro, OR 97123-1960 USA